

The Roundtable of Population Health Improvement presents

The Ecosystem of Health Equity Measures



NATIONAL
ACADEMIES

*Sciences
Engineering
Medicine*

ATTENDEE PACKET
JUNE 2023

The Ecosystem of Health Equity Measures

JUNE 21, 2023 | 8:30 AM - 4:30 PM PT

Table of Contents

1	Agenda
3	Roundtable of Population Health Improvement Roster
5	Biosketches of Speakers, Moderators and Planning Committee
12	Readings and Resources
21	Statement of Discrimination, Harassment, and Bullying
22	Directions and Parking
25	Map
26	Local Eateries in Uptown Oakland

Roundtable on Population Health Improvement | Roundtable on the Promotion of Health Equity

The Ecosystem of Health Equity Measures *or*

Moving from Disparities to Equity to Solutions: Metrics that Matter

A Workshop

June 21, 2023

The California Endowment | 2000 Franklin Street, Oakland

[Live webcast](#)

DRAFT AGENDA

Learning Objectives

- Critique concepts, language, narratives, and framing of measurement of health equity
- Examine the nature and purposes of health equity metrics for transformational change (for information, accountability, galvanizing action)
- Discuss the state of the science (social and political implications for designing data collection and methods)
- Explore measures at different scales and/or levels of the socioecological model of health
- Emphasize asset-based perspective as a throughline

8:30am PT	Welcome and Overview Dialogue Ana Diez Roux , <i>roundtable co-chair; Drexel University</i> Sheri Johnson , <i>planning committee co-chair; University of Wisconsin, Madison</i>
8:45am	1 Opening talks: History, concepts, framing Paula Braveman , <i>University of California, San Francisco</i> Andrew Anderson , <i>Tulane University</i>
9:30am	2 The state of the science on metrics and data sources Moderator: Fernando De Maio , <i>DePaul University and the American Medical Association</i> Speakers: Carolyn Liebler , <i>University of Minnesota</i> Sam Harper , <i>McGill University (virtual)</i> Amy Branum , <i>National Center for Health Statistics, CDC</i> (Please take a break as needed)

- 10:30am **Discussion**
- 10:50am **3 An overview of health equity measurement efforts in health care/hospitals**
Moderator: **Philip Alberti**, AAMC
Speakers:
Rachel Harrington, NCQA
Rukiya Curvey Johnson, Rush University System for Health (virtual)
Vikas Saini, The Lown Institute (virtual)

Discussion
- 12:20pm **LUNCH BREAK**
- 1:20pm **4 Communities as co-creators of measures and data, and as drivers of the measurement agenda**
Moderator: **Hanh Cao Yu**, planning committee co-chair; The California Endowment
Speakers:
Ryan Petteway, Oregon Health & Science University – Portland State University
Somava Saha, WE in the World, WIN Network
Paul Speer, Vanderbilt University

Discussion
- 2:40pm **Break**
- 2:55pm **5 Multi-sector measures/integrating data and measures from non-health sectors**
Moderator: **Rachel Thornton**, Nemours (virtual)
Speakers:
Julia Kaufman, RAND Corporation
Erin McDonald, Office of the Assistant Secretary for Health, HHS (virtual)
Adria Crutchfield, Baltimore Regional Housing Partnership (virtual)

Discussion
- 4:15pm **Closing reflections**
Ray Baxter, roundtable co-chair; Blue Shield of California Foundation and CDC Foundation

This event was planned by the following experts: Sheri Johnson, University of Wisconsin – Madison; Hanh Cao Yu, The California Endowment; Philip Alberti, Association of American Medical Colleges; Fernando De Maio, DePaul University and the American Medical Association; Rachel Thornton, Nemours; Ana Jackson, Blue Shield of California Foundation

Note: The planning committee's role is limited to organizing the event. A proceedings based on the event will be prepared by an independent rapporteur.

HEALTH AND MEDICINE DIVISION

Roundtable on Population Health Improvement Roster

Vision | A thriving, healthful, and equitable society

Mission | In recognition that health and quality of life for all are shaped by interdependent historical and contemporary social, political, economic, environmental, genetic, behavioral, and health care factors, the Roundtable on Population Health Improvement exists to provoke and catalyze urgently needed multi-sector community engaged collaborative action.

Members

Raymond Baxter, PhD (Co-Chair)

Trustee, Blue Shield of California Foundation
Board Member, CDC Foundation
San Francisco, CA

Ana V. Diez Roux, MD, PhD, MPH (Co-Chair)

Dana and David Dornsife Dean and
Distinguished University Professor
of Epidemiology
Dornsife School of Public Health
Drexel University
Philadelphia, PA

Philip M. Alberti, PhD

Senior Director, Health Equity Research
and Policy
Association of American Medical Colleges
Washington, DC

Debbie I. Chang, MPH

President and CEO
Blue Shield of California Foundation
San Francisco, CA

Marc N. Gourevitch, MD, MPH

Professor and Chair
Department of Population Health
NYU Langone Health
New York, NY

Meg Guerin-Calvert, MPA

Senior Managing Director and
President, Center for Healthcare Economics
and Policy
FTI Consulting
Washington, DC

Hilary Heishman, MPH

Senior Program Officer
Robert Wood Johnson Foundation
Princeton, NJ

Dora Hughes, MD, MPH

Senior Advisor,
Center for Medicare and Medicaid Innovation
Centers for Medicare and Medicaid Services
U.S. Department of Health and Human Services
Washington, DC

Sheri Johnson, PhD

Director, Population Health Institute
Professor (CHS), Department of Population
Health Sciences
School of Medicine and Public Health
University of Wisconsin-Madison
Madison, WI

Robert M. Kaplan, PhD

Professor, Center for Advanced Study
in the Behavioral Sciences
Stanford University
Stanford, CA

Milton Little, MA

President
United Way of Greater Atlanta
Atlanta, GA

Bobby Milstein, PhD, MPH

Director
ReThink Health
Morristown, NJ

José T. Montero, MD, MHCDS
Director, Office for State, Tribal, Local
and Territorial Support (OSTLTS)
Deputy Director
Centers for Disease Control and Prevention
Atlanta, GA

Willie (Billy) Oglesby, PhD
Interim Dean
College of Population Health
Jefferson University
Philadelphia, PA

Jason Purnell, PhD
Vice President of Community Health
Improvement
BJC Health Care
Associate Professor
Brown School at Washington University
in St. Louis
St. Louis, MO

Kosali Simon, PhD
Herman B. Wells Endowed Professor
Associate Vice Provost for Health Sciences
Paul H. O'Neill School of Public and
Environmental Affairs
Indiana University
Bloomington, IN

Kara Odom Walker, MD, MPH, MSHS
Senior Vice President and Chief Population
Health Officer
Nemours Children's Health
Washington, DC

Terry Williams, MBA, Dip. Econ.
Executive Vice President and Chief Population,
Corporate & Government Affairs Officer
Atrium Health
Winston-Salem, NC

Hanh Cao Yu, PhD
Chief Learning Officer
The California Endowment
Oakland, CA

The Ecosystem of Health Equity Measures

A Workshop



Biosketches of Speakers, Moderators, and Planning Committee Members

*denotes planning committee member, †denotes roundtable member
(Twitter handles provided where available)

Andrew Anderson

 [@andrew_andersn](https://twitter.com/andrew_andersn)

Andrew Anderson, M.H.A., Ph.D., is an assistant professor in the Department of Health Policy & Management at the Tulane School of Public Health and Tropical Medicine. His work aims to identify the social, behavioral, and environmental drivers of health outcomes to inform the development of policy that supports high-quality, equitable health care. Prior to Tulane, Andrew was a research scientist and Phyllis Torda health care quality fellow at the National Committee for Quality Assurance (NCQA) and a director of quality measurement at the National Quality Forum (NQF). He is also a former health policy research scholar with the Robert Wood Johnson Foundation.

Philip Alberti*†

 [@PM_Alberti](https://twitter.com/PM_Alberti)

Phillip Alberti, Ph.D., is the Founding Director of the AAMC Center for Health Justice and Senior Director, Health Equity Research & Policy at the Association of American Medical Colleges (AAMC). Dr. Alberti sparks, supports, and contributes to community-driven, multi-sector efforts that build evidence for programs, policies, practices, and partnerships that eliminate health inequities.

A population health scientist whose singular professional commitment to health equity research and action spans over 20 years, Dr. Alberti is a nationally recognized thought leader on the diverse roots of health inequities and the structural solutions required to ensure all communities thrive. Widely published and a sought-after public speaker, he has served on advisory boards and expert panels for numerous organizations and federal agencies including the Centers for Disease Control and Prevention, the National Institutes of Health, and the Centers for Medicare & Medicaid Services.

Prior to joining AAMC in 2012, Dr. Alberti led research, evaluation, and planning efforts for a Bureau within the NYC Department of Health and Mental Hygiene that worked to promote health equity between NYC neighborhoods. He holds a Ph.D. degree in Sociomedical Sciences from Columbia University's Mailman School of Public Health and was a Fellow in the National Institute of Mental Health's Psychiatric Epidemiology Training program.

Ray Baxter†

Raymond Baxter, Ph.D., currently serves as the co-chair of the Population Health Roundtable of the National Academies of Science, Engineering and Medicine; a Trustee of the Blue Shield of California Foundation; and a member of the Board of Directors of the CDC Foundation. Dr. Baxter most recently was CEO of the Blue Shield of California Foundation. He currently serves on the advisory boards to the Deans of the UC Berkeley School of Public Health and the UCSF School of Nursing.

For 15 years, Dr. Baxter was Kaiser Permanente's national senior vice president for community benefit, research and

health policy. There he built the largest community benefit program in the US, investing over \$2 billion annually in community health. He led Kaiser Permanente's signature national health improvement partnerships, including the Weight of the Nation, the Convergence Partnership and the Partnership for a Healthier America. Dr. Baxter also established Kaiser Permanente's Center for Effectiveness and Safety Research and built out its national genomics research bank, served as President of KP International, and chaired Kaiser Permanente's field-leading environmental stewardship work. He was a founding sponsor of the KP School of Medicine.

Previously he headed the San Francisco Department of Public Health, the New York City Health and Hospitals Corporation, and The Lewin Group. Dr. Baxter holds a doctorate from Princeton University. In 2001 the University of California, Berkeley, School of Public Health honored him as a Public Health Hero for his service in the AIDS epidemic in San Francisco. In 2006 he received the CDC Foundation Hero Award for addressing the health consequences of Hurricane Katrina in the Gulf Coast. In 2016, the San Francisco Business Times recognized his philanthropic contributions with its first Legacy Award.

Paula Braveman

 [@PaulaBraveman](https://twitter.com/PaulaBraveman)

Paula Braveman, M.D., M.P.H. is Professor of Family and Community Medicine and Founding Director of the Center for Health Equity at the University of California, San Francisco (UCSF). For more than 25 years, Dr. Braveman has studied and published extensively on health equity and the social determinants of health, and has worked to bring attention to these issues in the U.S. and internationally.

Her research has focused on measuring, documenting, understanding, and addressing socioeconomic and racial/ethnic disparities, particularly in maternal and infant health. During the 1990s she collaborated with World Health Organization staff in Geneva to develop a global initiative on equity in health and health care. She has been the Research Director for a national commission on the social determinants of health in the U.S. supported by the Robert Wood Johnson Foundation. Throughout her career, she has collaborated with local, state, federal, and international health agencies to see rigorous research translated into practice with the goal of achieving greater equity in health. She was elected to the Institute of Medicine of the U.S. National Academy of Sciences in 2002 and has served on the Advisory Council of the National Institute for Minority Health and Health Disparities of NIH.

Adria Crutchfield

 [@BRHP](https://twitter.com/BRHP)

Adria Crutchfield, M.P.P., is an affordable housing and community development Leader with public service experience that spans federal, state, and local government legislative and executive branches. Since February 2019, she has served as the Executive Director of the Baltimore Regional Housing Partnership (BRHP), dedicated to helping families escape poverty through access to high-quality housing in areas with strong schools, low crime, and ample job opportunities.

Immediately prior to joining BRHP, Crutchfield served as Chief of Staff at the New York City Department of Buildings where she advised the Commissioner on the administration and execution of agency priorities including organizational restructuring, improving the safety of construction sites, and the Mayor's goals to develop affordable housing; support small businesses; and build a more sustainable, and equitable City. Previously, Crutchfield worked as the Senior Advisor to the Executive Vice President for Capital Projects at the New York City Housing Authority, the largest public housing authority in the country. In this capacity, she supported the day-to-day operations and management of 400 employees responsible for planning, designing, and delivering a \$2 billion, five-year construction program.

She has held roles in external affairs, issue advocacy, and coalition building focused on improving the quality of life of vulnerable populations and creating vibrant cities. Crutchfield serves on the board of directors of the Maryland Association of Housing and Redevelopment Agencies (MAHRA) and as board chair of housing mobility nonprofit, Mobility Works. Previously, she served on the Biden-Harris Transition HUD Agency Review Team and Baltimore Mayor Brandon Scott's Housing Committee Transition Team. She was a part of the 2022 cohort of The Leadership, a not-for-profit organization committed to strengthening Baltimore by developing and connecting the region's civic leaders.

Crutchfield is a graduate of Washington University in St. Louis where she studied architecture and American University where she earned her master's in public policy. She is a proud alum of Coro Leadership New York.

Rukiya Curvey Johnson [@RCJohnsonSTEM](https://twitter.com/RCJohnsonSTEM)

Rukiya Curvey Johnson, M.B.A., is Vice President of Community Health Equity and Engagement at Rush University System for Health. As vice president, Curvey Johnson will continue leading Rush's efforts to dismantle barriers to longer, healthier lives in the communities Rush serves through economic, educational, structural and health-related initiatives and community partnerships. She has been serving as interim vice president since early 2022 while also leading the Rush Education and Career Hub (REACH) as its executive director.

Curvey Johnson previously was director of community health and engagement, a role she assumed in 2020 at the height of the COVID-19 pandemic while also leading REACH. She oversaw the launch of COVID-19 contact tracing and the Community Health Worker Hub, food security initiatives and community partnerships.

Curvey Johnson joined Rush in 2017 to establish and lead REACH — the continuation and transformation of Rush's Science and Math Education Network — which provides Black, Latino and other underrepresented young people with innovative, hands-on STEM learning opportunities to open doors to careers in health care and science, technology, engineering and math. Curvey Johnson previously served as executive director of STEM and strategic initiatives at Chicago Public Schools, where she led the development and execution of the school district's K-12 STEM strategy.

She earned a master's degree in business administration from the University of Michigan's Stephen M. Ross School of Business and a Bachelor of Arts in psychology and Spanish from the University of Virginia.

Fernando de Maio* [@fernandodemaio](https://twitter.com/fernandodemaio)

Fernando De Maio, Ph.D., is Vice President of Health Equity Research and Data Use at the American Medical Association's Center for Health Equity, and a Professor of Sociology at DePaul University. His research and teaching interests lie primarily within medical sociology and social epidemiology, with a focus on the concept of structural violence. Dr. De Maio's work has been guided by the notion of 'radical statistics' – the idea that statistical analysis can be used to not just describe the world, but to change it. He is the author of *Health & Social Theory* (Palgrave Macmillan, 2010) and *Global Health Inequities* (Palgrave Macmillan, 2014), and co-editor of *Latin American Perspectives on the Sociology of Health and Illness* (Routledge, 2018), *Community Health Equity: A Chicago Reader* (University of Chicago Press, 2019), and most recently, *Unequal Cities: Structural Racism and the Death Gap in America's Largest Cities* (Johns Hopkins University Press, 2021). His work has appeared in the *New England Journal of Medicine*, the *Journal of Epidemiology of Community Health*, *Critical Public Health*, the *Journal of the American Medical Association* and other health care and social science journals.

Dr. De Maio served as a founding co-director of the DePaul-Rush Center for Community Health Equity from 2014 to 2022. In 2019 he received the Dr. Steve Whitman research award from Health and Medicine Policy Research Group for "promoting social justice and challenging inequities in health and healthcare". In 2020 he received the Cortelyou-Lowery Award for excellence from the College of Liberal Arts and Social Sciences at DePaul University. He currently serves as a commissioner on the Robert Wood Johnson Foundation's National Commission to Transform Public Health Data Systems.

Dr. De Maio received a B.A. degree in Sociology and Economics from the University of Toronto, and his M.A. in Sociology and Health Studies and Ph.D. (Sociology) degrees from the University of Essex.

Ana Diez Roux† [@adiezroux](https://twitter.com/adiezroux)

Ana V. Diez Roux, M.D., Ph.D., M.P.H., is the Dana and David Dornsife Dean and Distinguished University Professor of Epidemiology at the Dornsife School of Public Health and Director of the Drexel Urban Health Collaborative. Originally trained as a pediatrician in her native Buenos Aires, she completed public health training at the Johns Hopkins University School of Hygiene and Public Health. Before joining Drexel University, she served on the faculties of Columbia University and the University of Michigan, where she was Chair of the Department of Epidemiology and Director of the Center for Social Epidemiology and Population Health. Dr. Diez Roux is internationally known for her research on the social determinants of population health and the study of how neighborhoods affect health. Her work on neighborhood health effects has been highly influential in the policy debate on population health and its determinants.

Dr. Diez Roux has served on numerous editorial boards, review panels and advisory committees including most recently the Clean Air Scientific Advisory Committee (CASAC) of the Environmental Protection Agency (as Chair), the Board of Scientific Counselors (BSC) of the National Center for Health Statistics, the Committee on Health and Wellbeing in the Changing Urban Environment of the International Council for Science (ISCUS), and CDC's Community Preventive Services Taskforce. She has received the Wade Hampton Frost Award for her contributions to public health from the American Public Health Association and the Award for Outstanding Contributions to Epidemiology from the American College of Epidemiology. She is also an elected member of the American Epidemiological Society and the Academy of Behavioral Medicine Research. She was elected to the National Academy of Medicine of the National Academy of Sciences in 2009.

Sam Harper

Sam Harper, M.S.P.H., Ph.D., is an Associate Professor in the Department of Epidemiology, Biostatistics & Occupational Health at McGill University. He is also a member of the McGill University Centre on Population Dynamics and McGill's Public Policy and Population Health Observatory. Dr. Harper also holds an endowed chair of Impact of Health and Social Policy on Health Inequalities at Erasmus University Medical Center. His research focuses on understanding population health and its social distribution, with specific interests in impact evaluation, measuring health inequalities, global health, demography, causal inference, and ethical issues in public health.

Dr. Harper received his B.A. in biology from Westminster College, his M.S.P.H. in epidemiology at the University of South Carolina, and his Ph.D. in epidemiologic science from the University of Michigan.

Rachel Harrington

 [@rl_harrington](https://twitter.com/rl_harrington)

Rachel Harrington, Ph.D., is a Senior Research Scientist at the National Committee for Quality Assurance (NCQA), where she leads organizational efforts to build an evidence base to advance equitable, high quality, health care. This includes methods to promote transparency, incentivize reduction of inequities and develop equitable systems of care. In this role she directs the Equity in HEDIS program and research on novel approaches to measuring health equity, including data considerations and methods to evaluate disparities in quality performance.

Dr. Harrington has also done extensive work in the areas of risk adjusted utilization, appropriate medication use, and patient engagement in research. Before joining NCQA, she was a fellow at the University of Illinois at Chicago Institute for Health Research and Policy. Prior to that, she spent over 10 years in the pharmaceutical industry, with roles in regulatory affairs and health economics. Dr. Harrington holds a Ph.D. in Pharmacy Systems, Outcomes and Policy from the University of Illinois at Chicago.

Ana Jackson*

Ana Jackson, Ph.D., is Chief Evaluation and Data Strategy Director at Blue Shield of California Foundation. She leads the Foundation's evaluation and data strategy, centered around assuring that the Foundation and its grantees and stakeholders have access to the information they need to support systems change, advance equity, and assess learning and progress to improve health and end domestic violence.

Before joining the Foundation, Dr. Jackson spent 11 years at the Center for Evaluation and Analytics at the Kaiser Permanente Care Management Institute. As director of evaluation, she led comprehensive program evaluations, applying a broad range of qualitative and quantitative methods. Her team was essential to continuous improvement efforts for Kaiser Permanente's 12 million members.

Dr. Jackson has taught courses at University of California, Berkeley and San Francisco State University and held research positions spanning the areas of education, public policy, and health care. She was the founding director of the YWCA Racial Justice Program at UC Berkeley, where she established an anti-racism seminar, developed a curriculum for teens to teach anti-racism to younger students, and established several initiatives to combat systemic racism. She also led tobacco prevention and control efforts with the city of Berkeley and UC Berkeley and later became the lead evaluator for the city of Berkeley's tobacco prevention and control program. She was the former chair of the Alameda County Public Health Commission and a board member at the West Berkeley Foundation, and she received a Koshland Civic Leadership Award from the San Francisco Foundation. Dr. Jackson currently serves as president of the board at Stiles Hall.

Dr. Jackson holds a bachelor's degree in social welfare and a Ph.D./Master of Public Policy from UC Berkeley.

Sheri Johnson*†

Sheri Johnson, Ph.D., is Director of the Population Health Institute; Associate Professor (CHS), Department of Population Health Sciences, and Associate Director of Community Partnerships for the Prevention Research Center at the University of Wisconsin–Madison, School of Medicine and Public Health. Dr. Johnson has dedicated her 25+ year career to partnering with children, families, community organizations and systems to advance health and well-being. Awed by the resilience of individuals and communities, she is motivated to remove unfair obstacles and conditions that create and perpetuate health inequities.

Dr. Johnson completed undergraduate studies at Brown University; earned a M.A. and Ph.D. in clinical psychology at Boston University and served as a Clinical Fellow in Psychology at Harvard Medical School. She was previously Director of Behavioral Health at Milwaukee Health Services, Inc., a federally qualified health center and served as the Administrator and State Health Officer for the Wisconsin Division of Public Health. Immediately prior to joining the Population Health Institute, she was Associate Professor of Pediatrics at the Medical College of Wisconsin Center for Advancement of Underserved Children where she collaborated with diverse stakeholders to address a broad range of real-world problems.

Julia Kaufman

 [@juliahkaufman](https://twitter.com/juliahkaufman)

Julia Kaufman, M.A., Ph.D., is an Associate Research Department Director for the Behavioral and Policy Sciences Department and a Senior Policy Researcher at the RAND Corporation. She also codirects the RAND American Educator Panels. Her research focuses on how states and school systems can support high-quality instruction and student learning, as well as methods for measuring educator perceptions and instruction.

Dr. Kaufman has led studies in a range of areas from the implementation of K–12 state standards and curriculum materials to factors that support adult and child civic literacy, identity, and engagement. She has also worked closely with a number of state departments of education to support their reform efforts through research and analysis, including the Louisiana Department of Education and a Council of Chief State School Officer network aimed at increasing adoption and use of high-quality instructional materials. Dr. Kaufman has also led studies to investigate the implementation, outcomes, and costs associated with pipelines for preparing, hiring, and supporting high-quality school leaders and teachers. Lastly, she has done considerable work to develop innovative measures of instructional practice, including measures of student-centered learning and teachers' mathematics instruction.

Dr. Kaufman holds a Ph.D. in international education from New York University and an M.A. in teaching from the University of Pittsburgh.

Carolyn Liebler

Carolyn Liebler, M.S., Ph. D., is both an Associate Professor of Sociology and a Faculty Affiliate of the Institute for Social Research and Data Innovation at the University of Minnesota-Twin Cities. Her research focuses on the intersection of population studies and the social construction of race, with a special emphasis on how data on Indigenous peoples and tribal nations can be interpreted and used in good way. Dr. Liebler completed the NIH-funded demography training program at the University of Wisconsin's Center for Demography and Ecology and her post-doctoral training was at the Minnesota Population Center working with IPUMS USA.

Dr. Liebler has a B.A. degree in sociology with a minor in statistics from Rice University, and M.S. and Ph.D. degrees in sociology from the University of Wisconsin-Madison.

Erin McDonald

Erin McDonald, M. P.P., Ph.D., is the Lead for the Federal Plan for Equitable Long-Term Recovery and Resilience in the Office of the Assistant Secretary of Health where she leads the whole-of-government effort across over 35 departments and agencies to build long-term resilience.

Before stepping into this role, she was the Regional Administrator for the Administration for Children and Families (ACF)

in Region 3, where she leads ACF's strategic cross-cutting initiatives and priorities to promote the economic wellbeing of children and families. Prior to joining federal service, Dr. McDonald served in leadership roles in public sector, philanthropic, and non-profit organizations including the Chief Strategy Officer for Human Services in the New York City Mayor's Office, the Vice President of Research and Strategy at Feeding America, and the Director of Research and Evaluation at Women's World Banking.

Dr. McDonald holds a PhD in Public Health and Research from Johns Hopkins Bloomberg School of Public Health, a master's in public policy and Evaluation from Johns Hopkins Policy Studies Institute.

Ryan Petteway

 [@RJPway4EQ](https://twitter.com/RJPway4EQ)

Ryan J. Petteway, Ph.D., is a Public Health Professor/Scholar and Educator who integrates social epidemiology, participatory research, and creative arts to advance health equity. He engages critical, Black feminist, and decolonizing theory and methods to pursue procedural and epistemic justice within public health research/practice, including via music and poetry. His current research and scholarship engages two general areas: 1) notions of "place", embodiment, and "placemaking" in community health, and the social, economic, and political processes that govern the spatial distribution of health opportunities, and 2) epistemic, procedural, and distributive justice within public health knowledge production processes, e.g. considerations of power and epistemic justice.

Dr. Petteway's scholarship and creative works have been honored with multiple Society for Public Health Education paper of the year awards (2021, 2022), a data visualization prize from the American Association of Geographers (2019), a national poetry month prize (2020), a Pushcart Prize nomination (2020), and selections as finalist or short/long list for various other prizes. His research has appeared in a range of top-tier public health journals, including Social Science & Medicine, Journal of Urban Health, and Health Education & Behavior. His poetry has appeared in both peer-reviewed public health and traditional poetry journals, including Health Promotion Practice, International Journal of Epidemiology, Critical Public Health, Kith, and Bellevue Literary Review. Dr. Petteway is an alum of the University of Virginia, University of Michigan, and UC Berkeley, and still reps The Ville.

Somava Saha

 [@somavasaha](https://twitter.com/somavasaha)

Somava Saha, M.D., M.S. is currently President and CEO of Well-being and Equity in the World (WE in the World), as well as Executive Lead of the Well Being In the Nation (WIN) Network, which work together to advance inter-generational well-being and equity. Over the last five years, as Vice President at the Institute for Healthcare Improvement, Dr. Saha founded and led the 100 Million Healthier Lives (100MLives) initiative, which brought together 1850+ partners in 30+ countries reaching more than 500 million people to improve health, wellbeing and equity. She and her team at WE in the World continue to advance and scale the frameworks, tools, and outcomes from this initiative as a core implementation partner in 100MLives.

Previously, Dr. Saha served as Vice President of Patient Centered Medical Home Development at Cambridge Health Alliance, where she co-led a transformation that improved health outcomes for a safety net population above the national 90th percentile, improved joy and meaning of work for the workforce, and reduced medical expense by 10%. She served as the founding Medical Director of the CHA Revere Family Health Center and the Whidden Hospitalist Service, leading to substantial improvements in access, experience, quality and cost for safety net patients.

In 2012, Dr. Saha was recognized as one of ten inaugural Robert Wood Johnson Foundation Young Leaders for her contributions to improving the health of the nation. She has consulted with leaders from across the world, including Guyana, Sweden, the United Kingdom, Singapore, Australia, Tunisia, Denmark and Brazil. She has appeared on a panel with the Dalai Lama, keynoted conferences around the world, and had her work featured on Sanjay Gupta, the Katie Couric Show, PBS and CNN. In 2016 she was elected as a Leading Causes of Life Global Fellow.

Paul Speer

Paul Speer, Ph.D., is a Professor, Department of Human and Organizational Development at Vanderbilt University. Dr. Speer teaches Community Development Theory, a course examining various theories that address the development of urban areas in the postwar era. The course examines the intersection of economics, politics, demographics, technology and other forces shaping the urban form and the quality of interactions in these spaces. He also teaches community

organizing, a course exploring expressions of agency by local actors on more macro-level processes, and the tools and methods for developing power to enhance agentic actions. He's also recently taught Action Research, Research Experience, and HOD Honors.

Dr. Speer's research interests focus on community organizing, social power and community change. He studies the processes and mechanisms of community organizations as these groups work to alter social conditions in their communities. Additionally, he is interested in linking these organizational processes to their associated impacts on the broader community as well as the impacts on individual participants. He serves on the editorial boards of Journal of Urban Affairs and the American Journal of Community Psychology.

Dr. Speer is currently involved in several community-based studies that draw on action research and participatory engagement with residents. He is working with an NIH-funded study of youth safety and wellbeing and a CDC-funded study of using media to alter community norms to reduce youth violence. He is studying community organizing processes in a statewide effort with PICO California. Paul is also working on a study of community organizing efforts that are working to prevent the opioid crisis in Detroit, Cleveland, and Cincinnati.

Rachel Thornton*

Rachel J. Thornton, M.D., Ph.D., is Vice President and Chief Health Equity Officer at Nemours Children's Health. In this role, Dr. Thornton leads the organization's work on an enterprise-wide health equity strategy and coordination in support of Nemours Children's vision to create the healthiest generations of children.

Prior to joining Nemours Children's, Dr. Thornton was the inaugural executive director for clinical services in the Johns Hopkins Medicine Office of Population Health where she led efforts to optimize clinical services for population health management and support community health. She has committed her career to health equity research and practice, including organizational transformation.

From work in medical education to research advancing equitable healthcare delivery and health equity, Dr. Thornton is focused on improving outcomes for children, families, and communities. She has experience translating research into policy at the local, state, and federal levels, serving as health policy advisor at the U.S. Department of Housing and Urban Development from 2011-2013. She also served as a member of the National Academies of Sciences, Engineering, and Medicine Report Shaping Summertime Experiences: Opportunities to Promote Healthy Development and Well-Being for Children and Youth and was also a member of the National Academy of Science, Engineering, and Medicine Strategy Group on COVID and Rental Evictions.

Dr. Thornton is a clinically practicing board-certified pediatrician. She received a B.A. from New York University, an M.D. from Johns Hopkins School of Medicine, and a PhD in health policy and management from Johns Hopkins Bloomberg School of Public Health. After residency, she completed fellowship training in general academic pediatrics.

Hanh Cao Yu*†



Hanh Cao Yu, Ph.D., is the Chief Learning Officer at the California Endowment (TCE) where she oversees learning, strategic development, evaluation, and impact activities, and ensures that local and state grantees, board and staff understand the results and lessons of the Foundation's investments in its 10-year Building Healthy Communities (BHC) initiative. BHC focuses on social determinants of health, policy systems change through a community-driven, power building approach.

Dr. Yu 25-year career span the research, evaluation, philanthropic sectors. Prior to joining TCE, served as Vice President at Social Policy Research Associates, where she oversaw much of the research and evaluation work in education, philanthropy and adolescent development. Dr. Yu has more than 20 years of experience in qualitative and quantitative research in the areas of health and racial equity social change philanthropy, leadership development, organizational effectiveness, policy advocacy evaluation, community organizing, and vulnerable populations. As a researcher at Stanford University, Dr. Yu is the author of numerous publications, including Adolescent World: Navigating the Multiple Worlds of Family, Peers, and School (Teachers' College Press, 1998), The Handbook on Leadership Development Evaluation (Jossey-Bass, 2006) and served on the RISE for Boys and Men of Color Advisory Group in 2016.

THE ECOSYSTEM OF HEALTH EQUITY

MEASURES

A Workshop



Readings and Resources

History, Concepts, and Framing of Measuring Health Equity

Braveman P. Defining Health Equity. *J Natl Med Assoc.* 2022 Dec;114(6):593-600. doi:10.1016/j.jnma.2022.08.004. Epub 2022 Sep 24. PMID: 36167751.

Braveman, P. "Health Disparities and Health Equity: Concepts and Measurement." *Annu Rev Public Health* 27 (2006): 167-94. <https://doi.org/10.1146/annurev.publhealth.27.021405.102103>.

Braveman PA, Arkin E, Proctor D, Kauh T, Holm N. Systemic And Structural Racism: Definitions, Examples, Health Damages, And Approaches To Dismantling. *Health Aff (Millwood)*. 2022 Feb;41(2):171-178. doi: 10.1377/hlthaff.2021.01394. PMID: 35130057.

Braveman, P., and S. Gruskin. "Defining Equity in Health." *J Epidemiol Community Health* 57, no. 4 (Apr 2003): 254-8. <https://doi.org/10.1136/jech.57.4.254>.

Braveman, P. A., S. Kumanyika, J. Fielding, T. Laveist, L. N. Borrell, R. Manderscheid, and A. Troutman. "Health Disparities and Health Equity: The Issue Is Justice." *Am J Public Health* 101 Suppl 1, no. Suppl 1 (Dec 2011): S149-55. <https://doi.org/10.2105/ajph.2010.300062>.

Braveman P, Parker Dominguez T. Abandon "Race." Focus on Racism. *Front Public Health.* 2021 Sep 7;9:689462. doi: 10.3389/fpubh.2021.689462. PMID: 34557466; PMCID: PMC8452910.

Gennuso, K. P. et al. Deaths of Despair(ity) in Early 21st Century America: The Rise of Mortality and Racial/Ethnic Disparities. *American Journal of Preventive Medicine*, Volume 57, Issue 5, 585 - 591

Dover, D. C., and A. P. Belon. "The Health Equity Measurement Framework: A Comprehensive Model to Measure Social Inequities in Health." *International Journal for Equity in Health* 18, no. 1 (2019/02/19 2019): 36. <https://doi.org/10.1186/s12939-019-0935-0>.

Penman-Aguilar, A., M. Talih, D. Huang, R. Moonesinghe, K. Bouye, and G. Beckles. "Measurement of Health Disparities, Health Inequities, and Social Determinants of Health to Support the Advancement of Health Equity." *J Public Health Manag Pract* 22 Suppl 1, no. Suppl 1 (Jan-Feb 2016): S33-42. <https://doi.org/10.1097/phh.0000000000000373>.

- The Leadership Conference Education Fund. *Data for Equity: A Review of Federal Agency Equity Action Plans*. (The Leadership Conference Education Fund, 2023). <https://civilrights.org/wp-content/uploads/2023/04/Data-For-Equity-Report.pdf>.
- Thimm-Kaiser, Marco, Adam Benzekri, and Vincent Guilamo-Ramos. "Conceptualizing the Mechanisms of Social Determinants of Health: A Heuristic Framework to Inform Future Directions for Mitigation." *The Milbank Quarterly* (Apr 16, 2023). <https://onlinelibrary.wiley.com/doi/abs/10.1111/1468-0009.12642>.
- University of Wisconsin Population Health Institute. County Health Rankings National Findings Report 2023. <https://www.countyhealthrankings.org/reports/2023-county-health-rankings-national-findings-report>

State of the Science: Metrics and Data Sources

- Bailit, M., and D. Kanneganti. "A Typology for Health Equity Measures." *Health Affairs Forefront* (March 21, 2022). <https://doi.org/10.1377/forefront.20220318.155498>.
- Besser, Richard. "Comments from Richard Besser, MD on the Initial Proposals for Updating OMB's Race and Ethnicity Statistical Standards." Robert Wood Johnson Foundation, 2023, <https://www.rwjf.org/en/insights/advocacy-and-policy/regulatory-comments/2023/04/comments-from-richard-besser-on-the-initial-proposals-for-updating-omb-race-and-ethnicity-statistical-standards.html>.
- Davis, Rachel. *Measuring What Works to Achieve Health Equity: Metrics for the Determinants of Health*. (Prevention Institute, June 2015). <https://www.preventioninstitute.org/publications/measuring-what-works-achieve-health-equity-metrics-determinants-health>.
- "Gear- Getting Equity Advocacy Results." 2014-2017, <https://gear.policylink.org/gear/measurement-strategies/tools-and-resources>.
- González-Hermoso, Jorge, and Robert Santos, "Separating Race from Ethnicity in Surveys Risks an Inaccurate Picture of the Latinx Community," *Urban Wire*. Urban Institute, 2019, <https://www.urban.org/urban-wire/separating-race-ethnicity-surveys-risks-inaccurate-picture-latinx-community>.
- "Racial and ethnic categories are social constructs, defined and designed by those who have historically held positions of influence. Our data collection instruments continue to echo this influence, yet the relevance of separate race and ethnic constructs is lagging while society evolves to create new labels and categories that better reflect people's views and experiences—labels like *Latinx*, *Mestizo/Mestiza*, *Negro/Negra*, and *Afro-Latinx*."
- Harper, Sam, Nicholas B. King, Stephen C. Meersman, Marsha E. Reichman, Nancy Breen, and John Lynch. "Implicit Value Judgments in the Measurement of Health Inequalities." *The Milbank Quarterly* 88, no. 1 (2010): 4-29. <http://www.jstor.org/stable/40586534>.
- Harper, Sam, and John Lynch. "Health Inequalities: Measurement and Decomposition." (2016). <https://ssrn.com/abstract=2887311> or <http://dx.doi.org/10.2139/ssrn.2887311>.
- Kauh, T. J., T. A. Minnis, M. Anand, M. Berry, and R. Gold. "Building an Equitable Future through Data Disaggregation." *Health Equity* 7, no. 1 (2023): 251-60. <https://doi.org/10.1089/heq.2023.29036.rtd>.

Office of Management and Budget. *Revisions to the Standards for the Classification of Federal Data on Race and Ethnicity*. Washington, DC: Executive Office of the President, 1997.
<https://www.whitehouse.gov/wp-content/uploads/2017/11/Revisions-to-the-Standards-for-the-Classification-of-Federal-Data-on-Race-and-Ethnicity-October30-1997.pdf>

Health Equity Measurement in Health Care and Hospitals

"Advancing Standardized Health Equity Quality Measurement." 2023, <https://www.ncqa.org/health-equity/measure-accountability/>.

Ansell, David A., Darlene Oliver-Hightower, Larry J. Goodman, Omar B. Lateef, and Tricia J Johnson. "Health Equity as a System Strategy: The Rush University Medical Center Framework." *NEJM Catalyst* 2, no. 5 (2021). <https://doi.org/10.1056/CAT.20.0674>.

Kilbourne, Amy M., Galen Switzer, Kelly Hyman, Megan Crowley-Matoka, and Michael J. Fine. "Advancing Health Disparities Research within the Health Care System: A Conceptual Framework." *American Journal of Public Health* 96, no. 12 (2006): 2113-21. <https://doi.org/10.2105/ajph.2005.077628>.

National Committee for Quality Assurance. *Advancing Health Equity: A Recommended Measurement Framework for Accountability in Medicaid*. (NCQA, 2022). https://www.ncqa.org/wp-content/uploads/2022/10/NCQA-CHCF-EquityFrmwrkMedicaid-Sep22_FINAL.pdf

National Committee for Quality Assurance. *Measuring Health Equity: A Review of Scoring Approaches*. (NCQA, 2023 2023). https://www.ncqa.org/wp-content/uploads/2023/02/NCQA-MeasuringHealthEquity-Whitepaper-FINAL_WEB.pdf

Perlin, J., and A. Plough. "Health Systems Need to Transform Data Collection to Advance Health Equity." *Population Health Management* 26, no. 2 (Apr 2023): 128-31.
<https://doi.org/10.1089/pop.2023.0005>.

Plott, Caroline. "Measuring Hospital Contributions to Community Health with a Focus on Equity." Johns Hopkins Bloomberg School of Public Health, 2021. <https://americanhealth.jhu.edu/news/measuring-hospital-contributions-community-health-focus-equity>.

Plott, Caroline F., Rachel L.J. Thornton, Irene Dankwa-Mullan, Ekta Punwani, Hema Karunakaram, Kyu Rhee, Kelly Jean Thomas Craig, and Joshua M. Sharfstein, "New Hospital Rankings Assess Hospitals' Contributions to Community Health with a Focus on Equity." *Health Affairs Blog*, 2021, <https://www.healthaffairs.org/content/forefront/new-hospital-rankings-assess-hospitals-contributions-community-health-focus-equity>.

Plott, Caroline F., Rachel L. J. Thornton, Ekta Punwani, Irene Dankwa-Mullan, Hema Karunakaram, Kelly Jean Thomas Craig, Kyu Rhee, and Joshua M. Sharfstein. "The Development and Implementation of a New Hospital Performance Measure to Assess Hospital Contributions to Community Health and Equity." *Health Services Research* 57, no. S2 (2022): 304-14.
<https://onlinelibrary.wiley.com/doi/abs/10.1111/1475-6773.14018>.

"Rise to Health: A National Coalition for Equity in Health Care." Rise To Health Coalition, 2023. <https://www.risetohealthequity.org/>.

Rush University Medical Center. *2018 Health Equity Report: Patient Care through an Equity Lens*. (RUSH University Medical Center, 2018). <https://healthequitychicago.org/wp-content/uploads/2019/08/2018-Health-Equity-Report.pdf>.

"The Racial Equity in Healthcare Progress Report." 2023. <https://www.rush.edu/about-us/rush-community/rush-bmo-institute-health-equity/racial-equity-healthcare-progress-report>.

Wittmer, Nancy, Maria Casaverde Marin, Cory Hussain, Ann Boyer, Rebecca Hanratty, Laura Jean Podewils, and Romana Hasnain-Wynia. "A Health System's Experience with Inclusive Race and Ethnicity Data Collection, and the Need for Data Equity Principles." *Health Affairs Forefront* (2023). <https://doi.org/10.1377/forefront.20230526.613731>.

The Role of Communities in Creating Measures and Data

"A New Tool to Improve Community Health." U.S. News and World Report, 2019, <https://www.usnews.com/news/health-news/articles/2019-06-03/well-being-in-the-nation-framework-aims-to-improve-community-health>.

"About Well Being in the Nation Measures." WIN Network, <https://insight.livestories.com/s/v2/win-measures/2fda874f-6683-49bd-adb2-22f6f3c5a718/>.

"Community Science." 2023, <https://communityscience.com/>.

Farhang, L., and X. Morales. "Building Community Power to Achieve Health and Racial Equity: Principles to Guide Transformative Partnerships with Local Communities." *NAM Perspectives* (Commentary), June 13, 2022. <https://doi.org/10.31478/202206d>.

Farrow, Frank, Hanh Cao Yu, and Robert Ross. "Philanthropic Investment in People Power." *Stanford Social Innovation Review* (2022): 46-53. <https://doi.org/10.48558/5MK9-W722>. https://ssir.org/articles/entry/philanthropic_investment_in_people_power.

Iton, A., R. K. Ross, and P. S. Tamber. "Building Community Power to Dismantle Policy-Based Structural Inequity in Population Health." *Health Affairs* 41, no. 12 (Dec 2022): 1763-71. <https://doi.org/10.1377/hlthaff.2022.00540>.

Pastor, M., P. Speer, J. Gupta, H. Han, and J. Ito. "Community Power and Health Equity: Closing the Gap between Scholarship and Practice." *NAM Perspectives* (Discussion Paper), June 13, 2022. <https://doi.org/10.31478/202206c>.

Petteway, Ryan, Mahasin Mujahid, Amani Allen, and Rachel Morello-Frosch. "Towards a People's Social Epidemiology: Envisioning a More Inclusive and Equitable Future for Social Epi Research and Practice in the 21st Century." *International Journal of Environmental Research and Public Health* 16, no. 20 (2019): 3983. <https://www.mdpi.com/1660-4601/16/20/3983>.

Petteway, Ryan J. "On Epidemiology as Racial-Capitalist (Re)Colonization and Epistemic Violence." *Critical Public Health* 33, no. 1 (2023/01/01 2023): 5-12. <https://doi.org/10.1080/09581596.2022.2107486>.

- Petteway, Ryan J. "Place, Health, and the Geography of Embodiment: Intergenerational Participatory Research for Representation/as Resistance in the Ville." In *Representation, Re-Presentation, and Resistance: Participatory Geographies of Place, Health, and Embodiment*, 97-116. Cham: Springer International Publishing, 2022. https://doi.org/10.1007/978-3-031-06141-7_5
- Petteway, Ryan J. "Presence//Gifted: On Poetry, Antiracism, and Epistemic Violence in Health Promotion." *Health Promotion Practice* 24, no. 1 (2023): 37-44. <https://doi.org/10.1177/15248399221129535>.
- Petteway, Ryan J., and Lourdes A. González. "Engaging Public Health Critical Race Praxis in Local Social Determinants of Health Research: The Youth Health Equity and Action Research Training Program in Portland." *International Journal of Environmental Research and Public Health* 19, no. 13 (2022): 8187. <https://www.mdpi.com/1660-4601/19/13/8187>.
- Petteway, Ryan J., Mahasin Mujahid, Amani Allen, and Rachel Morello-Frosch. "The Body Language of Place: A New Method for Mapping Intergenerational "Geographies of Embodiment" in Place-Health Research." *Social Science & Medicine* 223 (2019/02/01/ 2019): 51-63. <https://www.sciencedirect.com/science/article/pii/S0277953619300279>
- Speer, Paul , Jyoti Gupta, and Krista Haapanen. *A Research Agenda for Developing and Measuring Community Power for Health Equity*. Vanderbilt University (2020). <https://static1.squarespace.com/static/5ee2c6c3c085f746bd33f80e/t/5f89f10f74988d6050aea648/1602875664986/Forward+Looking+Research+Agenda+%281%29.pdf>.
- Speer, Paul, Jyoti Gupta, and Krista Haapanen. *Developing Community Power for Health Equity: A Landscape Analysis of Current Research and Theory*. Vanderbilt University (2020). <https://static1.squarespace.com/static/5ee2c6c3c085f746bd33f80e/t/5f89f1325e27a51436c97b74/1602875699695/Landscape+-+Developing+Community+Power+for+Health+Equity+%281%29.pdf>.
- Statistics, National Committee on Vital and Health. *NCVHS Measurement Framework for Community Health and Well-Being, V4*: Department of Health and Human Services, 2017. <https://ncvhs.hhs.gov/wp-content/uploads/2018/03/NCVHS-Measurement-Framework-V4-Jan-12-2017-for-posting-FINAL.pdf>
- The Annie E. Casey Foundation, "How Residents in Baltimore Are Redefining Community Research." *The Annie E. Casey Foundation*, 2022, <https://www.aecf.org/blog/how-residents-in-baltimore-are-redefining-community-research>.
- "United Nations Permanent Forum on Indigenous Issues Twenty-Second Session: 17-28 April 2023." United Nations, 2023, <https://social.desa.un.org/issues/indigenous-peoples/unpfii/unpfii-twenty-second-session-17-28-april-2023>.
- Vaidya, A., A. Poo, and L. Brown. "Why Community Power Is Fundamental to Advancing Racial and Health Equity." *NAM Perspectives* (Commentary), June 13, 2022. <https://nam.edu/why-community-power-is-fundamental-to-advancing-racial-and-health-equity/>.
- "Well-Being in the Nation (WIN) Measures." 2023, <https://www.winmeasures.org/>.

Data and Measures from Non-Health Sectors

American Institutes for Research. *Bridges Collaborative Member Profile: Baltimore Regional Housing Partnership (BRHP)*. (American Institutes for Research, 2022).

<https://www.air.org/sites/default/files/2023-03/Bridges-Collaborative-Member-Profile-Baltimore-BHRP-TCF-Feb-2023.pdf>.

Centers for Medicare and Medicaid Services. *Innovation Center Strategy Refresh*.
<https://innovation.cms.gov/strategic-direction-whitepaper>.

Craig, Dena. "The Leadership Conference Education Fund Releases Federal Civil Rights Data Collection Report." The Leadership Conference Education Fund, 2022,
<https://civilrights.org/edfund/2022/04/25/the-leadership-conference-education-fund-releases-federal-civil-rights-data-collection-report/>.

Environmental Protection Agency. "Environmental Quality Index (EQI)." Updated February 17, 2023.
<https://www.epa.gov/healthresearch/environmental-quality-index-eqi>.

"Equitable Long-Term Recovery and Resilience: All People and Places Thriving, No Exceptions." Office of Disease Prevention and Health Promotion, Updated November 18, 2022, <https://health.gov/our-work/national-health-initiatives/equitable-long-term-recovery-and-resilience>.

Jahn, J. L., and S. M. Hernandez. "Mortality Inequities: Power, Theory, and Data Considerations." *Am J Public Health* 0, no. 0 (May 18, 2023): e1-e3,
<https://ajph.aphapublications.org/doi/pdf/10.2105/AJPH.2023.307322>

Hughes, Dora Lynn. "CMS Innovation Center Launches New Initiative to Advance Health Equity." *Health Affairs Forefront* (2022). <https://doi.org/10.1377/forefront.20220302.855616>.

Kaufman, Julia H., Melissa Kay Diliberti, Douglas Yeung, and Jennifer Kavanagh. *Defining and Measuring Civic Infrastructure*. Santa Monica, CA: RAND Corporation, 2022. doi:10.7249/rra112-24.
https://www.rand.org/pubs/research_reports/RR112-24.html.

LaVeist, Thomas A., Eliseo J. Pérez-Stable, Patrick Richard, Andrew Anderson, Lydia A. Isaac, Riley Santiago, Celine Okoh, et al. "The Economic Burden of Racial, Ethnic, and Educational Health Inequities in the US." *JAMA* 329, no. 19 (2023): 1682-92. <https://doi.org/10.1001/jama.2023.5965>

RAND Health Care. *Developing Health Equity Measures*. (U.S. Department of Health and Human Services: May 2021). https://aspe.hhs.gov/sites/default/files/migrated_legacy_files/200651/developing-health-equity-measures.pdf.

The Commission on the Practice of Democratic Citizenship. *Our Common Purpose: Reinventing American Democracy for the 21st Century*. (American Academy of Arts and Sciences, 2020).
https://www.amacad.org/sites/default/files/publication/downloads/2020-Democratic-Citizenship_Our-Common-Purpose.pdf.

"Thriving Together." Well Being Trust, 2023, <https://thriving.us/>.

Roundtable on Population Health Improvement and other National Academies Publications

- Institute of Medicine. *For the Public's Health: The Role of Measurement in Action and Accountability*. Washington, DC: The National Academies Press, 2011. <https://doi.org/10.17226/13005>.
- National Academies of Sciences, Engineering, and Medicine. *Metrics That Matter for Population Health Action: Workshop Summary*. Washington, DC: The National Academies Press, 2016. <https://doi.org/10.17226/21899>.
- National Academies of Sciences, Engineering, and Medicine. *Civic Engagement and Civic Infrastructure to Advance Health Equity: Proceedings of a Workshop*. Washington, DC: The National Academies Press, 2023. doi:10.17226/26590. <https://nap.nationalacademies.org/catalog/26590/civic-engagement-and-civic-infrastructure-to-advance-health-equity-proceedings>.
- National Academies of Sciences, Engineering, and Medicine. *Communities in Action: Pathways to Health Equity*. Washington, DC: The National Academies Press, 2017. doi:10.17226/24624. <https://nap.nationalacademies.org/catalog/24624/communities-in-action-pathways-to-health-equity>.
- National Academies of Sciences, Engineering, and Medicine. *Community Power in Population Health Improvement: Proceedings of a Workshop*. Washington, DC: The National Academies Press, 2022. doi:10.17226/26306. <https://nap.nationalacademies.org/catalog/26306/community-power-in-population-health-improvement-proceedings-of-a-workshop>.
- National Academies of Sciences, Engineering, and Medicine. *Leading Health Indicators 2030: Advancing Health, Equity, and Well-Being*. Washington, DC: The National Academies Press, 2020. doi:10.17226/25682. <https://nap.nationalacademies.org/catalog/25682/leading-health-indicators-2030-advancing-health-equity-and-well-being>.
- National Academies of Sciences, Engineering, and Medicine. *Population Health Science in the United States: Trends, Evidence, and Implications for Policy: Proceedings of a Joint Symposium*. Washington, DC: The National Academies Press, 2022. doi:10.17226/25631. <https://nap.nationalacademies.org/catalog/25631/population-health-science-in-the-united-states-trends-evidence-and>.

Other / Miscellaneous

- Agénor, M., C. Perkins, C. Stamoulis, R. D. Hall, M. Samnaliev, S. Berland, and S. Bryn Austin. "Developing a Database of Structural Racism-Related State Laws for Health Equity Research and Practice in the United States." *Public Health Rep* 136, no. 4 (Jul-Aug 2021): 428-40. <https://doi.org/10.1177/0033354920984168>.
- Ahmed, Koushik, Desiree Scretching, and Sandra D. Lane. "Study Designs, Measures and Indexes Used in Studying the Structural Racism as A social Determinant of Health in High Income Countries from 2000–2022: Evidence from a Scoping Review." *International Journal for Equity in Health* 22, no. 1 (2023/01/06 2023): 4. <https://doi.org/10.1186/s12939-022-01796-0>.
- Hardeman, R. R., P. A. Homan, T. Chantarat, B. A. Davis, and T. H. Brown. "Improving the Measurement of Structural Racism to Achieve Antiracist Health Policy." *Health Affairs* 41, no. 2 (Feb 2022): 179-86. <https://doi.org/10.1377/hlthaff.2021.01489>.
- Probst, J., J. M. Eberth, and E. Crouch. "Structural Urbanism Contributes to Poorer Health Outcomes for Rural America." *Health Affairs* 38, no. 12 (Dec 2019): 1976-84. <https://doi.org/10.1377/hlthaff.2019.00914>.

"Structural Sexism: FSU Researcher Offers New Perspective on Gender and Health Inequality." Florida State University News, 2019, <https://news.fsu.edu/news/education-society/2019/05/29/structural-sexism-fsu-researcher-offers-new-perspective-on-gender-and-health-inequality/>.

PREVENTING DISCRIMINATION, HARASSMENT, AND BULLYING EXPECTATIONS FOR PARTICIPANTS IN NASEM ACTIVITIES

The National Academies of Sciences, Engineering, and Medicine (NASEM) are committed to the principles of diversity, integrity, civility, and respect in all of our activities. We look to you to be a partner in this commitment by helping us to maintain a professional and cordial environment. All forms of discrimination, harassment, and bullying are prohibited in any NASEM activity. This commitment applies to all participants in all settings and locations in which NASEM work and activities are conducted, including committee meetings, workshops, conferences, and other work and social functions where employees, volunteers, sponsors, vendors, or guests are present.

Discrimination is prejudicial treatment of individuals or groups of people based on their race, ethnicity, color, national origin, sex, sexual orientation, gender identity, age, religion, disability, veteran status, or any other characteristic protected by applicable laws.

Sexual harassment is unwelcome sexual advances, requests for sexual favors, and other verbal or physical conduct of a sexual nature that creates an intimidating, hostile, or offensive environment.

Other types of harassment include any verbal or physical conduct directed at individuals or groups of people because of their race, ethnicity, color, national origin, sex, sexual orientation, gender identity, age, religion, disability, veteran status, or any other characteristic protected by applicable laws, that creates an intimidating, hostile, or offensive environment.

Bullying is unwelcome, aggressive behavior involving the use of influence, threat, intimidation, or coercion to dominate others in the professional environment.

REPORTING AND RESOLUTION

Any violation of this policy should be reported. If you experience or witness discrimination, harassment, or bullying, you are encouraged to make your unease or disapproval known to the individual, if you are comfortable doing so. You are also urged to report any incident by:

- Filing a complaint with the Office of Human Resources at 202-334-3400, or
- Reporting the incident to an employee involved in the activity in which the member or volunteer is participating, who will then file a complaint with the Office of Human Resources.

Complaints should be filed as soon as possible after an incident. To ensure the prompt and thorough investigation of the complaint, the complainant should provide as much information as is possible, such as names, dates, locations, and steps taken. The Office of Human Resources will investigate the alleged violation in consultation with the Office of the General Counsel.

If an investigation results in a finding that an individual has committed a violation, NASEM will take the actions necessary to protect those involved in its activities from any future discrimination, harassment, or bullying, including in appropriate circumstances the removal of an individual from current NASEM activities and a ban on participation in future activities.

CONFIDENTIALITY

Information contained in a complaint is kept confidential, and information is revealed only on a need-to-know basis. NASEM will not retaliate or tolerate retaliation against anyone who makes a good faith report of discrimination, harassment, or bullying.

Updated June 7, 2018



The California Endowment



TCE'S CENTER FOR HEALTHY COMMUNITIES OAKLAND
2000 Franklin Street, Oakland, CA 94612
510-271-4333
www.calendow.org/the-center-for-healthy-communities

DIRECTIONS

BICYCLES:

- ✓ Street parking available
- ✓ 19th Street Bart [Bike Parking Information](#)

PUBLIC TRANSPORTATION:

Dial 511 (Bay area residents) or visit [511 Trip Planner](#)

BART: [Quick Planner & Real Time Departures](#)

Get off BART at **19th Street** Oakland Station

Use the 20th Street exit

The Oakland Conference Center is located on the corner of 20th & Franklin Street (next to Wells Fargo Bank).

AC TRANSIT (BUS):

The following bus lines serve the 19th Street BART area: **6, 11, 12, 14, 18, 51A, 72, 72M, 72R, 800, 802, 805, 851, NL**
[AC Transit Maps & Schedules](#)

DRIVING DIRECTIONS

From Contra Costa

1. Take Highway CA-24 W through the Caldecott Tunnel.
2. Take Highway I-980 W to the 18th Street exit.
3. Take the 18th/14th Street exit.
4. Turn left onto 17th Street. Follow 17th Street to Franklin Street.
5. Turn left onto Franklin Street.

The Oakland Conference Center is located on the right corner of 20th & Franklin Street (next to Wells Fargo Bank).

From Marin

1. Take the San Rafael Bridge to Highway I-580 and merge into to Interstate 80 W.
2. At the San Francisco /Oakland Interchange, take Highway I-580 E.
3. Merge onto I-980 W towards Downtown Oakland.
4. Take the 18th/14th Street exit.
5. Turn left on 17th Street. Follow 17th Street to Franklin Street.
6. Turn left on Franklin Street.

The Oakland Conference Center is located on the right corner of 20th & Franklin Street (next to Wells Fargo Bank).

From Pleasanton/Livermore

1. Take Highway I-580 W to Oakland.
2. Merge onto I-980 W towards Downtown Oakland.
3. Take the 18th/14th Street exit.
4. Turn left on 17th Street. Follow 17th Street to Franklin Street.
5. Turn left on Franklin Street

The Oakland Conference Center is located on the right corner of 20th & Franklin Street (next to Wells Fargo Bank).

From Sacramento

1. Take I-80 W to San Francisco.
2. Take the exit to I-580 E towards Downtown Oakland.
3. Merge onto I-980 W towards Downtown Oakland.
4. Take the 18th/14th Street exit.
5. Turn left on 17th Street. Follow 17th Street to Franklin Street.
6. Turn left on Franklin Street

The Oakland Conference Center is located on the right corner of 20th & Franklin Street (next to Wells Fargo Bank).

From San Francisco/Bay Bridge

1. Take the Bay Bridge/Oakland to I-80 E.
2. Merge onto I-980 W towards Downtown Oakland.
3. Take the 18th/14th Street exit.
4. Turn left on 17th Street. Follow 17th Street to Franklin Street.
5. Turn left on Franklin Street

The Oakland Conference Center is located on the right corner of 20th & Franklin Street (next to Wells Fargo Bank).

From Oakland International Airport

1. Take 880 North to the Broadway exit in Downtown Oakland.
2. Turn right at the first light onto Broadway.
3. Turn right onto 17th Street. Follow 17th Street to Franklin Street.
4. Turn left on Franklin Street

The Oakland Conference Center is located on the right corner of 20th & Franklin Street (next to Wells Fargo Bank).

PARKING

Telegraph Plaza Public Parking

Address: 2100 Telegraph Avenue Oakland 94612

Entrance: 21st & Telegraph Ave.

Hours: M-F 6:00am- 6:00pm

Rate: \$1.00/20 min, \$12.00/ Daily Max, \$8.00/ Early Bird (*in before 9:30am*), \$4.00/ Overnight, \$20.00/Lost Coin Fee

Diamond Parking

Address: 1975 Webster Street Oakland 94612

Entrance: Thomas L. Berkeley/ 20th & Webster, on Webster

Hours: 24 hours/ 7 days a week

Rate: \$2.53_{+tax}/20 min, \$17.72_{+tax} / Daily Max (up to 10 hrs.), \$21.10_{+tax}/Vans & Trucks, \$5.91_{+tax} / Motorcycles, Overnight, \$20/Lost Coin Fee

Douglas Parking/ California Bank & Trust

Address: 2003 Franklin Street Oakland 94612

Entrance: 20th & Franklin, on Franklin

Hours: 24 hours/ 7 days a week

Rate: \$3.00/30 min (*or fraction thereof), \$12.00 / All Day

**1 hour Free w Bank Validation*

Douglas Parking

Address: 450 21st Street Oakland 94612

Entrance: 21st Street, Between Broadway/Telegraph

Hours: 24 hours/ 7 days a week

Rate: \$10.00 / Daily Parking

Franklin Plaza Garage

Address: 1719 Franklin Street Oakland 94612

Entrance: 411 19th Street, off Franklin

Hours: M-F 7:00am- 8:00pm

Rate: \$1.00/20 min, \$18.00/ Daily Max, \$10.00/ Early Bird (*in before 9:30am*), \$4.00/ Evening (4-8pm), \$20.00/Lost Coin Fee

**Note: All rates are subject to change without notice.*

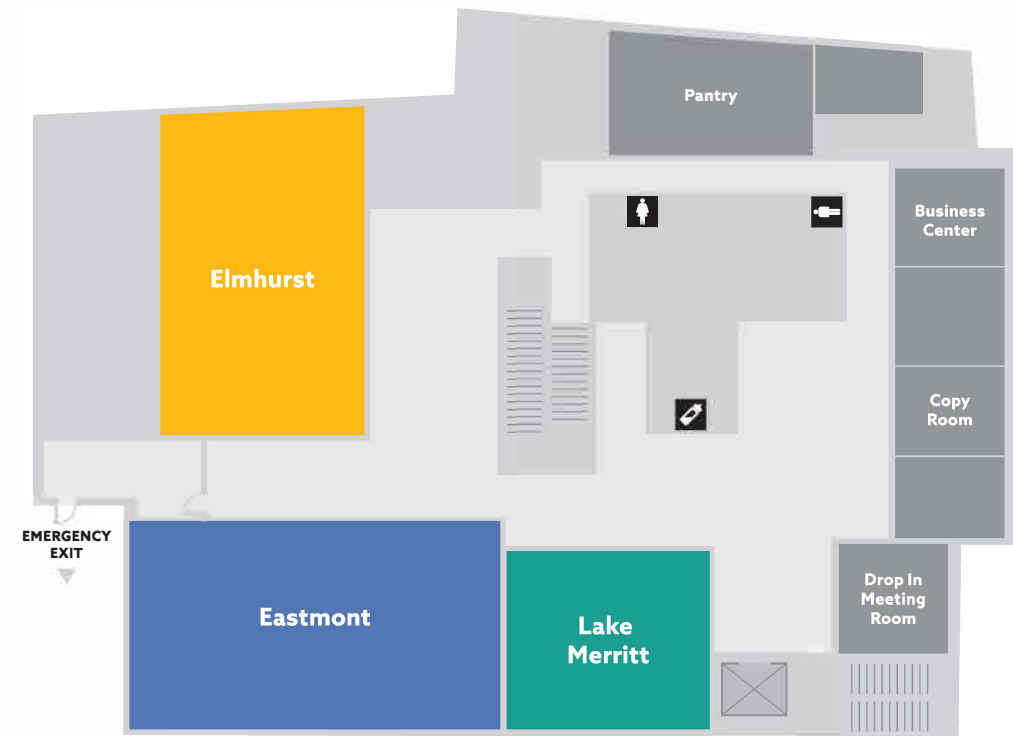

Coffee, Lunch & Desserts Uptown Oakland

<u>Agave Uptown</u> 2135 Franklin St 510-288-3668	<u>Aroma Cafe</u> 1900 Franklin St 510-763-3930	<u>Baygreens Salads & More</u> 2225 Webster St 510-419-0673	<u>Belly Uptown</u> 1901 San Pablo Ave 510-839-0000
<u>Burma Bear</u> 325 19th St 510-817-4413	<u>Café Umami</u> 25 Grand Ave 510-350-7277	<u>Coco Café</u> 1924 Franklin St 510-671-1592	<u>Deli Fresh</u> 404 22nd St 510-451-1634
<u>Extreme Pizza</u> 15 Grand Avenue 510-808-5234	<u>Falafel Boy</u> 1924 Franklin St 510-817-4863	<u>Farley's East</u> 33 Grand Ave 510-835-7898	<u>The Halal Guys</u> 2214 Broadway 510-808-5062
<u>Ib's Hoagies</u> 400 21st St 510-893-3944	<u>Ike's Place</u> 2204 Broadway 510-338-6789	<u>James & the Giant Cupcake</u> 341 17th St 510-823-2622	<u>La Bonita Taqueria</u> 2200 Broadway 510-663-3007
<u>The Lunch Box</u> 1720 Franklin St 510-836-0703	<u>Modern Coffee</u> 381 19 th Steet 510-858-7601	<u>Molcajete Cocina</u> 1734 Webster St. 510- 466-6652	<u>Mountain Mike's Pizza</u> 1830 Webster St 510-268-8226
<u>OSHA Thai Express</u> 326 23 rd St 415-651 4596	<u>Poke Parlor</u> 311 20th St 510-922-9895	<u>Shawarmaji</u> 2123 Franklin St 510-397-9817	<u>Sweet Bar</u> 2355 Broadway 510-788-4997
<u>Tacos La San Marqueña</u> <i>(Taco Truck)</i> 1975 Webster St 510-387-8763	<u>Tierra Mia Coffee</u> 2001 Broadway 510-986-0511	<u>Umami Burger</u> 2100 Franklin St 510-899-8626	<u>Yokee Milk Tea</u> 1728 Franklin St 510-836-3288